

FDMR EI 90 S (Remote solid wall construction)

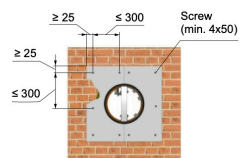
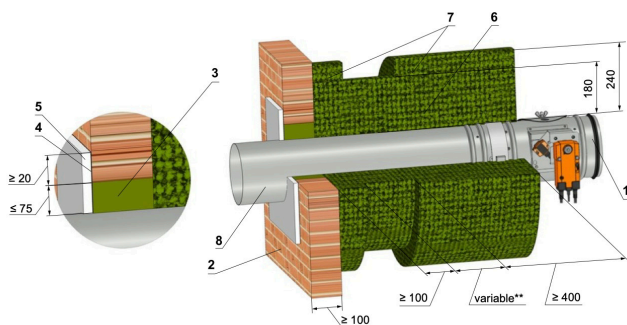

Screws has to be fixed in wall/ceiling construction. (If it is needed use steel bracket).

Position:

1. Fire damper
2. Solid wall construction
3. Stuffing box (mineral stone wool min. density 140 kg/m³)
4. Fire protection mastic min. thickness 1mm
5. Cement lime plate min. thickness 15mm (min. density 870 kg/m³)
6. Stone wool with one side stitched wire fencing (min. density 105 kg/m³ thickness 180 mm (e.g. 3x60 mm))
7. Stone wool with one side stitched wire fencing (min. density 105 kg/m³ thickness 60 mm)
8. Ductwork connected with breakaway joints

Used materials - example:

3. Promapyr. Rockwool Steprock HD. Hilti CFS-CT C 1S 140/50
4. Promastop - P, K, Hilti CFS-CT
5. Promatect - H
6. Rockwool Wired Mat 105 th. 3x60mm
7. Rockwool Wired Mat 105 th. 60mm

* Stuffing box, fire protection mastic, cement lime plate and insulation materials can be replaced by another approved fire sealing system for damper installation with equivalent material properties.

** Depends on the distance of the flap from the construction, when the maximum distance from the construct is not limited and according to EN 15882-2 must use the required number of supports according to 1366-1:2014.

For builders work opening (BWO) please refer to ductwork manufacturers tested penetration detail.

Insulation to be installed with manufacturers installation practices taking priority.

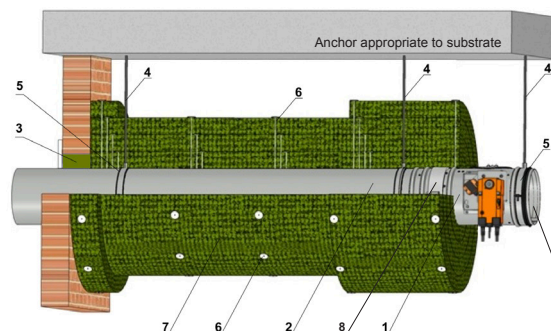

Position:

1. Fire damper
2. BS EN 1366-1 fire rated duct
3. Soft padding (stone wool + fire board)
4. Threaded rod
5. Suspension ring
6. Weld pin
7. Insulation
8. Extension piece (if required)
9. Extension piece to locate ring collar solid fixings required

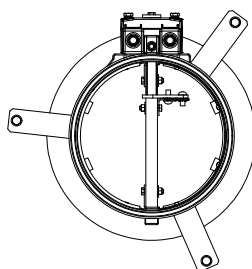

Circular suspension - DRSN

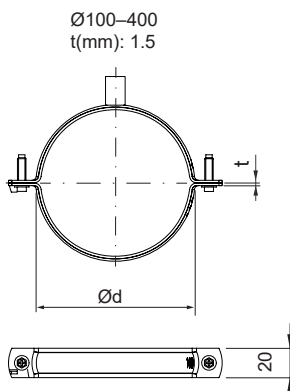

Ø100-400
With slotted quick closure.
With screw M6x20 and head: hex 1/4" and PH2.
Connection nut M8+M10.

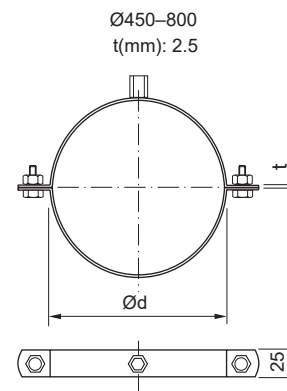

Ø450-800
With Ø 10 hole.
With bolt and nut H17 M10x30.
Connection nut M8+M10.

Advice provided by a fixing specialist contractor takes precedence.

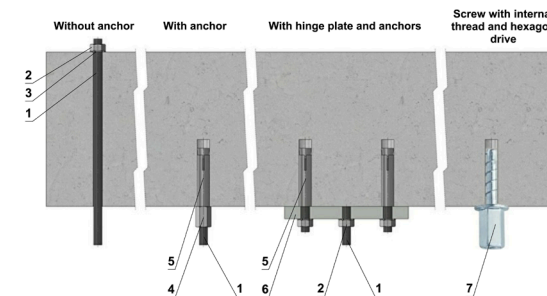

Hinge plates

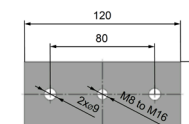

Screw with internal thread and hexagon drive

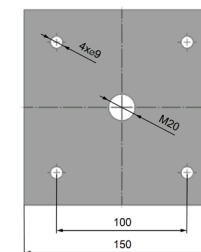
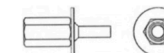

Load capacities of threaded hanger rods F [N] at the required fire resistance 90 minutes

Size	As [mm]	Weight G [kg]	
		for 1 piece	for 1 pair
M8	36.6	22	44
M10	58	35	70
M12	84.3	52	104
M14	115	70	140
M16	157	96	192
M18	192	117	234
M20	245	150	300

Position:

1. Threaded rod M8 - M20
2. Nut
3. Washer
4. Coupling nut
5. Anchor
6. Hinge plate - min. thickness 10mm
7. Concrete screw tested for fire resistance R30-R90, max. tension up to 0.75KN (length 35mm)

Drop rod diameter is based on damper weight, see full Damper TPM for further technical details or contact help@Mandik.co.uk. Mandik reserves the right to update this information without prior notice.

		Mandik UK Ltd www.mandik.co.uk Office: 0117 4526376	Redwood House Brotherswood Court Great Park Road Almondsbury Bristol BS32 4QW
		CE certified acc. to EN 15650	
Title: FDMR - Remote solid wall		Tested in accordance with EN 1366-2	
Classification: EI 90 (ve i<->o) S		Size: (min-max) 100x200 - 710x800	Date: 29/10/2021
Drawing No: 0000-0000-040 Rev 3		Illustrated: GP	Approved: MF
Intellectual property of MANDIK Ltd. Unauthorised use shall be punishable by law			